

ROTATORI IDRAULICI

I - Rotatori idraulici

GB - Hydraulic rotors

D - Hydraulische Drehmotoren

F - Rotateurs hydrauliques

E - Rotores hidráulicos



DISEGNO TECNICO / TECHNICAL DRAWING

GR 10 - GR 30 B - GR 46- GR 55 M

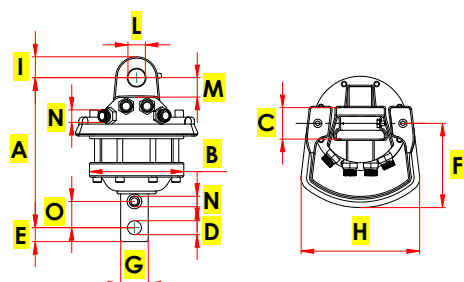

GR 30 PF- GR 465

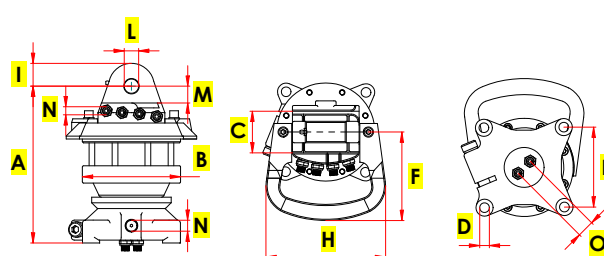

GR 60/69 DB - GR 110-1 DB

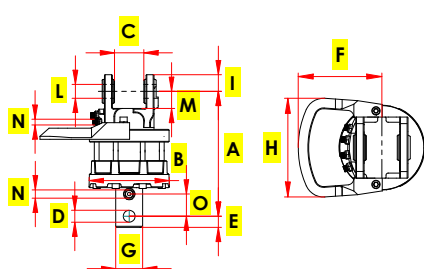

GR 603 DB - GR 104 DB- GR 12 S - GR 16 S

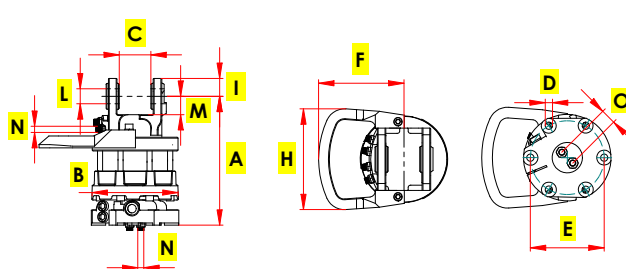

Modello/Type	Portata/Load	Rotation	Peso/Weight	Pressure	A	B	C	D	E	F	G	H	I	L	M	N	O
	Ton		kg	Max bar	mm	mm	mm	mm	mm	mm	mm	mm	mm	mm	mm	mm	mm
GR 10	1	360°	10	250	215	134	45	20	20	125	39,5	182	30	25	34	1/4	40
GR 30 B	3	360°	18	250	249	158	73	25	28,5	155	49,5	210	40	25	36	3/8	48
GR 30 PF	3	360°	24	250	230,5	158	73	17	140	155	-	210	40	25	36	3/8	-
GR 46	4,5	360°	23	250	273	172	73	30	28	155	59	210	40	25	36	3/8	56
GR 465	4,5	360°	27	250	255	172	73	17	140	155	-	210	40	25	36	3/8	30
GR 55 M	5,5	360°	29	250	273	184	73	30	28	174	69	212	40	30	40	3/8	56
GR 60/69 DB	6	360°	37	250	305	198	80,5	30	28	200	69	236	40	35	42	1/2	56
GR 603 DB	6	360°	43	250	297	198	80,5	17	173	200	-	236	40	35	42	1/2	36
GR 110-1 DB	10	360°	50	250	340,5	214	80,5	35	36	199	78	244	45	35	42	1/2	63
GR 104 DB	10	360°	59	250	331,5	214	80,5	17	173	200	-	244	45	35	42	1/2	40
GR 12 S	12	360°	70	250	362	224	100,5	17	173	199	-	249	55	45	58	1/2	40
GR 16 S	16	360°	71	250	375	224	100,5	17	173	199	-	249	55	45	58	1/2	40